



  
**Hilton**  
On the Park-Melbourne

# Setting the Style in Melbourne



# Fresh look rooms



After an investment of \$40 million, the Hilton on the Park – Melbourne offers over 400 revitalised rooms and suites with contemporary designs and comfortable furnishings.

The combination of beautifully selected furnishings with natural tones has created the most relaxing setting where guests are able to work, relax and enjoy, with absolute ease.

The hotel also features:

**eforea: spa** offering a range of therapeutic spa and beauty treatments.

**24-hour Fitness Centre** with an outdoor heated swimming pool, whirlpool spa, steam room, and sauna.

**Park Lounge**, the perfect spot to meet friends and enjoy a drink or a light snack.

**Gallery Restaurant**, which offers internationally inspired cuisine and an exquisite selection of fine wines.



# A kick away from all the **action**

Located in elegant East Melbourne, Hilton on the Park - Melbourne is in the heart of the city's sporting and entertainment district. Literally a kick away from all the action, the hotel is positioned directly opposite the Melbourne Cricket Ground (MCG), AAMI Park, Rod Laver Arena, Melbourne Park (home of the Australian Open tennis tournament) and the beautiful Fitzroy Gardens. The location offers convenience in exploring Melbourne, with trams and trains on the doorstep, and only a short walking distance to the city centre and famous shopping precincts.

The hotel features beautifully appointed accommodation rooms all with comfortable bedding, flat screen TVs, high speed wireless internet access and large opening windows.

The stunning Relaxation Suites present a new concept in hotel living, with three separate zones to promote a balance between work, enjoyment and relaxation.

The Executive Floor Rooms on the top levels of the hotel are a popular choice with their modern design and emphasis on style and space.

Executive Floor guests also enjoy access the exclusive Executive Lounge, offering amazing views and the perfect place to relax in comfortable seclusion while enjoying complimentary breakfast, refreshments throughout the day and pre-dinner drinks and canapés in the evening.



Hilton King Room



Relaxation Suite



Executive Lounge

# Setting a **new** standard in Conference & Event facilities

Presenting an impressive look and state of the art technology with a number of flexible rooms to suit any event.

The dedicated conference and events floor located on level 1 of the hotel is renowned for the large, open foyer space, gleaming with natural light and the adaptable rooms which are perfect for any event from boardroom meetings, training workshops and trade exhibitions through to weddings, conferences and gala dinners.



Boardroom Two

## Our Guarantee

At every meeting and event held at participating hotels in Australia or New Zealand we will offset the carbon emissions generated by the use of our meeting room and food consumed.

**We will do this at no additional cost to our clients.**

Rooms	Floor (metres)	Area (sq metres)	Height (metres)	Theatre Style	Classroom Style	Boardroom Style	Open Rounds	Dinner	Dinner/ Dance	Cocktail Style
Grand Ballroom (in total)	28.5 x 24.8	707	4.8	900	320	-	400	550	450	1000
Ballroom 1	7.6 x 24.8	188	4.8	140	70	-	96	120	-	150
Ballroom 2	7.6 x 24.8	193	4.8	140	70	-	96	120	-	150
Ballroom 3	13.0 x 24.8	322	4.8	280	130	-	144	220	170	300
Ballroom 1 & 2	15.4 x 24.8	382	4.8	280	140	-	200	300	200	350
Ballroom 2 & 3	20.8 x 24.8	515	4.8	400	200	-	240	340	240	400
Ballroom foyer	24.0 x 10.3	245	3	-	-	-	-	-	-	200
Upper foyer	39.8 x 14.3	490	3	-	-	-	-	-	-	390
Stradbroke room	8.3 x 11.1	92	3	64	36	22	40	60	-	60
Huntingfield room	6.3 x 11.1	70	3	56	35	20	40	50	-	50
Delacombe room	10.4 x 11.1	115	3	80	42	26	56	70	60	80
Stradbroke/Huntingfield/Delacombe room	25.0 x 11.1	277	3	220	144	-	128	180	150	250
Stradbroke/Huntingfield room	14.6 x 11.1	162	3	140	84	-	80	100	80	120
Huntingfield/Delacombe room	16.7 x 11.1	185	3	180	108	-	88	110	80	160
Latrobe room	9.8 x 9.8	96	3	48	24	14	24	40	-	50
Hotham room	4.8 x 7.1	34	3	20	12	12	-	16	-	16
Hopetoun room	7.8 x 7.1	55	3	30	21	14	-	24	-	30
Hotham/Hopetoun rooms	12.6 x 7.1	89	3	50	27	-	-	36	-	50
Boardroom 1	5.7 x 4.7	27	3	-	-	8	-	-	-	-
Boardroom 2	7.4 x 4	30	3	-	-	12	-	-	-	-
Epicurean	10.8 x 10.7	115.5	3	80	30	28	40	50	40	80
Jolimont	6 x 8	48	3	35	15	20	16	24	-	30
Cliveden room	8 x 9		3	-	-	-	-	80	60	80

Talk to the dedicated catering sales team at Hilton on the Park now about hosting your next event:

Ph: +61 3 9412 3163

Email: [events.melbourne@hilton.com](mailto:events.melbourne@hilton.com)

The Grand Ballroom is sure to astonish with a stunning new look and innovative use of technology.

From the moment guests enter the Grand Ballroom they will be overwhelmed by this room. Presenting plush décor accentuated with stunning lighting features, this fabulous space will always provide the perfect mood for every event.

The large open foyer, flooded with natural light, provides the perfect area for trade exhibitions and delegate breakout space where the great range of catering options can be enjoyed.

The addition of two new boardrooms and a Business Centre with state-of-the-art meeting technology and a comfortable environment will result in the most productive meetings.

The Governor's Wing, with an array of stunning rooms offers flexibility, natural light and picturesque views.

Or make your next event a delicious experience with the Epicurean Room, our unique demonstration kitchen space, where our Executive Chef and team can teach you the tricks of the trade and host fun, interactive cooking sessions.



Grand Ballroom



Epicurean Room

Hotel Floorplan

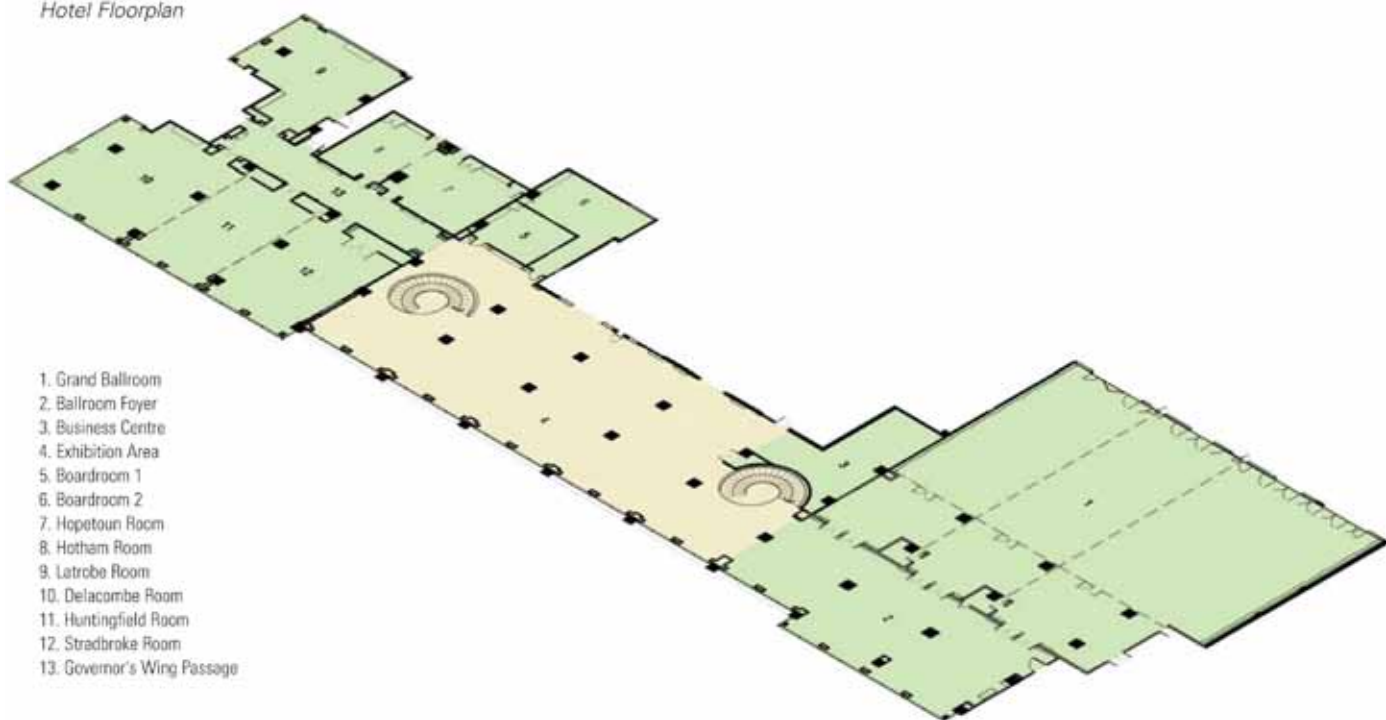



**Hilton**  
On the Park-Melbourne

AUSTRALIA

Hilton Adelaide

Hilton Brisbane

Hilton Cairns

Hilton Melbourne South Wharf

Hilton on the Park-Melbourne

Hilton Surfers Paradise

Hilton Surfers Paradise Residences

Hilton Sydney

Parmelia Hilton Perth

NEW ZEALAND, FIJI & FRENCH POLYNESIA

Fiji Beach Resort & Spa, managed by Hilton

Hilton Auckland

Hilton Bora Bora Nui Resort & Spa

Hilton Moorea Lagoon Resort & Spa

Hilton Lake Taupo

Hilton Queenstown

Kawarau Hotel, managed by Hilton

192 Wellington Parade,  
East Melbourne VIC 3002

Tel: 03 9419 2000

Fax: 03 9419 2001

Email: [melbourne.reservations@hilton.com](mailto:melbourne.reservations@hilton.com)

Web: [hiltonmelbourne.com.au](http://hiltonmelbourne.com.au)